

4-WAY BOX SUPPORT

SAVE UP TO 1 HOUR
PER INSTALLATION
WITH LESS MATERIAL



**Meets
NEC 3 Foot Rule
From Only
One Support**

SEE WEBSITE
VIDEO IP-1

4 Way

Cat#	4-Way Desc.	Wt. Ea.	Qty/Box
CSP-4W-WC (SS)	9-5/8" x 9-5/8" 18 Gauge Galvanized or Stainless Steel (SS)	0.7 lbs.	25

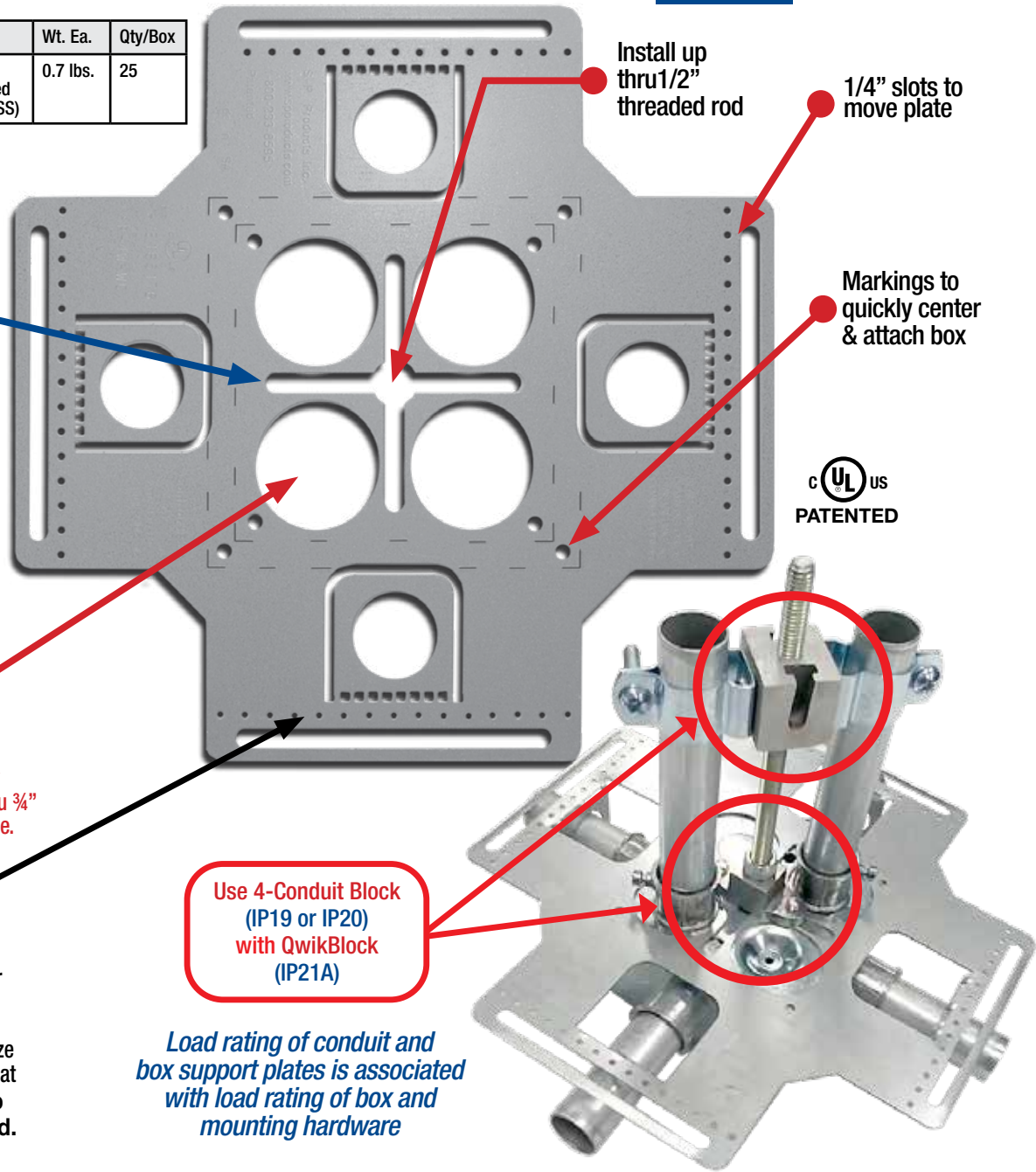

1
Eliminate center KO clamps for up thru 3/4" Conduit, Flex or equal size MC Cable entering all 4 sides of box at center KO location only. Bend tabs down, feed raceways thru openings to connectors on box. Holes for tek screws are also provided to attach conduit clamps when entering all other KO locations.

2
4 large open KOs in center allow entering back of box with up thru 3/4" raceways to save even more time.

3
Tek screw holes and 1/4" slots for nuts and bolts to install clamps facing down to support up thru 1 1/4" conduit and flex or equal size MC Cable entering all four sides at any KO location... or facing up for larger conduit overhead.

Use 4-Conduit Block (IP19 or IP20) with QwikBlock (IP21A)

Load rating of conduit and box support plates is associated with load rating of box and mounting hardware



SP PRODUCTS, INC
Productivity and value thru ideas



PATENT PENDING
PATENTED



LABELS APPLY TO PRODUCTS ONLY WHERE SHOWN ABOVE

730 Pratt Boulevard • Elk Grove Village, IL 60007
P: (847) 593-8595 • F: (847) 593-8629 • Toll-free (800) 233-8595
E: info@spproducts.com • www.spproducts.com

IP6